

Read more by scanning the QR code below



or by going to:

model-boats.com/70899



Italeri Vosper 72'6" MTB 77

by Ronald



26th Apr 2020

Italeri Vosper 72'6" MTB 77

Donnieboy gave me this kits several years ago to build with the grandsons. But, the boys are not able to come over to help grandpa. Plus, they really are not interested! Plan to make the conversion to a single brushed motor using an NiHM. Looking over the deck there needed to be a hatch opening with the least disturbance to the design. I chose the area as seen in the photos. Built a coaming, and a hatch cover which once the torpedoes are in place is hidden. I do not believe the raised deck will be very obvious.

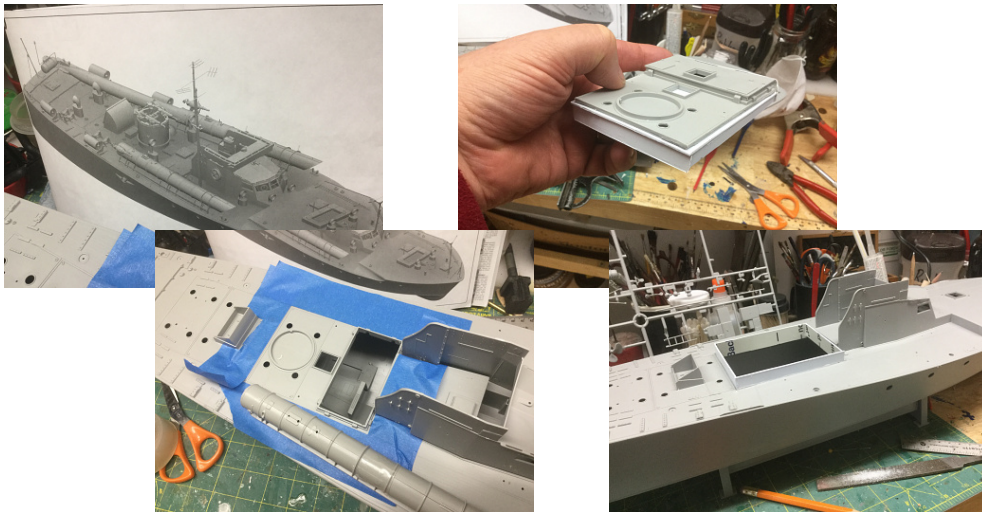

Model Boats Website!

10th May 2020

Ready to be water tested

Bathtub is too small to properly give this a water test. Once our pond is open for use, it will be water tested.



model-boats.com

Model Boats Website!

30th Apr 2020

Vosper MTB 77'

Found interior pictures of wheelhouse and helm. They really have helped. Also added coaming so the wheelhouse is removable.

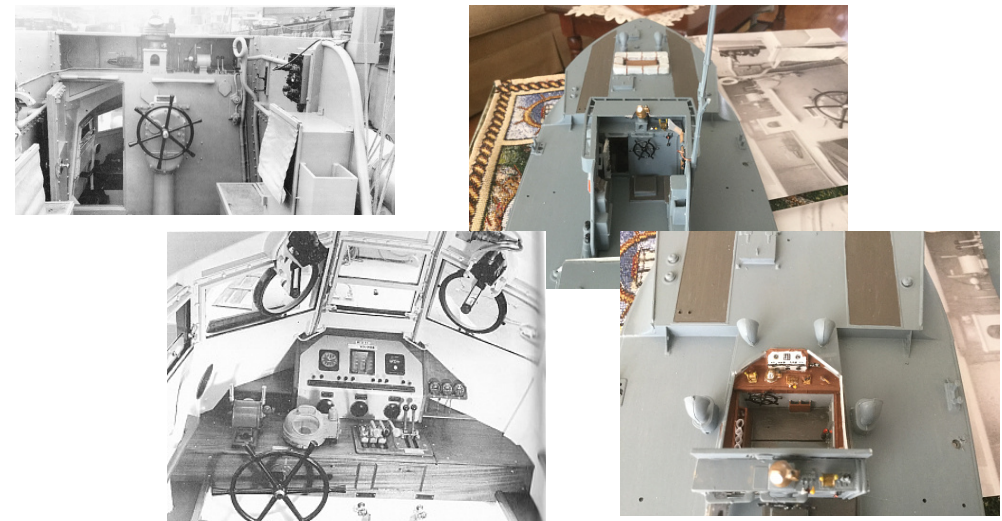

model-boats.com

30th Apr 2020

Vosper interior of helm

Added some imaginary items to the helm. Coffee mug, map n compass, wall cabinet, maps in the side compartment, additional gauges, and a picture of the yacht back home. Research noted that the floor had rubber mats in the wheelhouse and external helm. Also rubber was on the top of the cabinets as these were seats as well used for standing up on. The copper wire will be painted, it leads from the radio to the antenna. The speaking tube will also be painted once glue has dried.



10th May 2020

Do Not Trust the porthole material in the kit.

The kit came with funny windows that were self sticking which were for the port holes along both sides of the hull. I did not trust the self stick so added C.A. which I figured was good. After some spray paint got on a window, I was rubbing it to remove the paint. POP out came the port hole window! I checked the others and they also popped out with just a slight bit of pressure. Glad this happened on the workbench and not out on the water! In my resources, I keep clear packaging materials which work well for clear parts. Cut into strips, these were glued and clamped to the inside of the hull using C.A.: Watch those fumes!! I opened the window and turned on my exhaust fan, then went out closing the door behind me.

9th May 2020

Rigging and aerals?

What do most of you do to keep from damaging your rigging and radio aerals during transportation and when working around the model? Tonight, I remembered some stretchy "thread", it is white, but it comes in black too. However, fabric stores are closed for now, so the white will do the job for now. Made up wire hooks too, then with the stretchy material, the radio aerals would maintain their tension, but allow me to easily remove them and the mast when transporting and servicing the model.

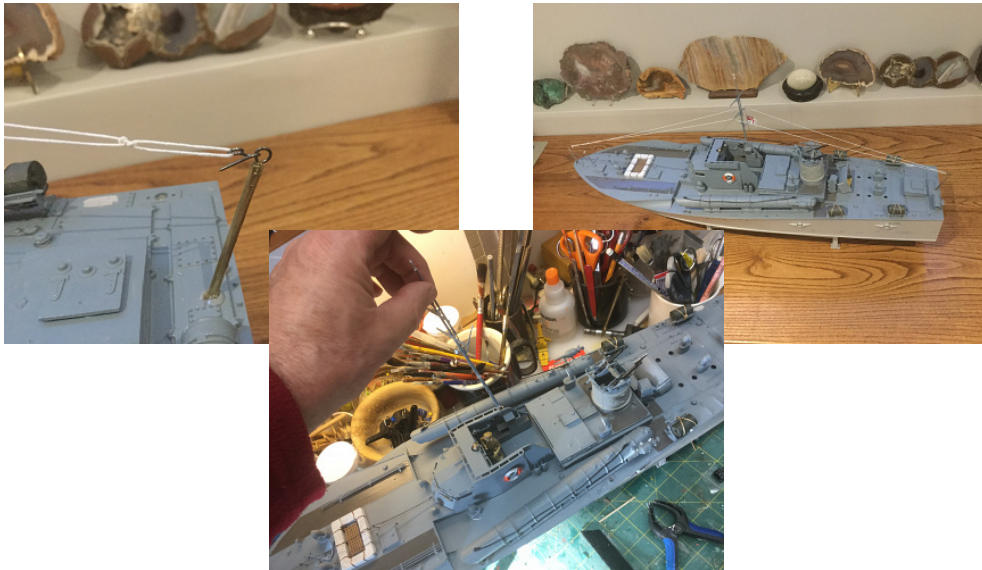

1st May 2020

Wheelhouse and Helm Arrangements

<https://servimg.com/view/16276837/2702#.WdnR8KF-wWA.pinterest>

3rd May 2020

Interior is Revealed

I am enjoying the work of Longshanks as found on the Britmodeller.com website. He is using the Italeri 1/35 Vosper 72' 6" MTB to create the interior of the boat beginning with the Wardroom & Radio shack located below the Helm. Osprey Publishing British Motor Torpedo Boat 1939-45 New Vanguard 74 Author: Angus Konstam Illustrator: Tony Bryan Short code: NVG 74 Publication Date: 20 Jun 2003 ISBN: 9781841765006 Format: Paperback Number of Pages: 48 The cover is an illustration of the MTB When I asked in an earlier post about how men came up on deck from down below? This illustration reveals the answer. The kit is wrong! Beside the ladder which drops down into the helm, there is a work table. That table surface is too long. It is half the length as it should be because there is another ladder leading below to the Officer's ward room and to the radio room. You can view this by seeing this link, and following all six pages, just keep scrolling along till the end. Absolutely Amazing! <https://www.britmodeller.com/foru>

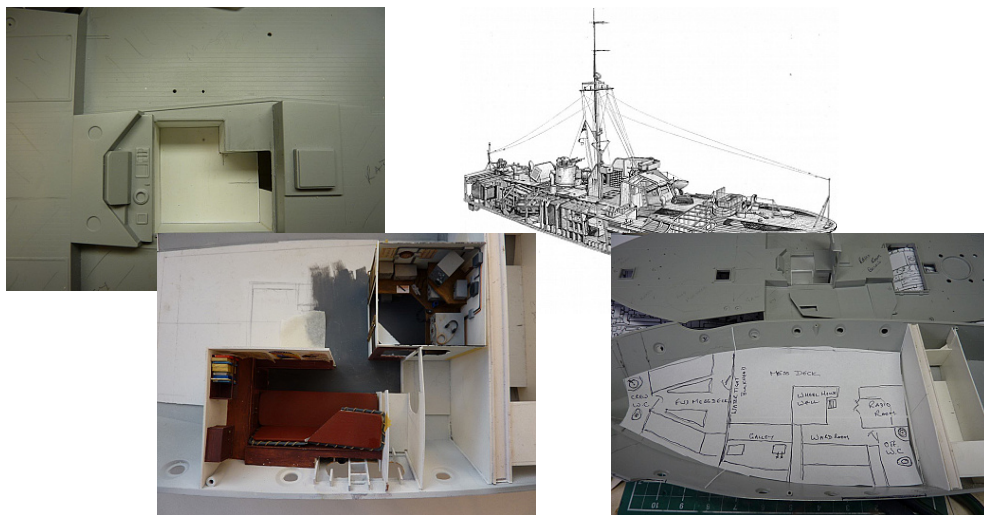

model-boats.com

8th May 2020

RC gear installed

After consultation with donnieboy the placement of the receiver was to keep it away from the motor so it was placed in the helm. It may stay as seen in the photos or mounted to the roof with Velcro. Don Sutton, Metro Marine Model Club, Toronto, is a valued friend who assists me with many aspects of my builds. He is a generous man with his knowledge and stock of supplies. A switch was added to the floor of the wheelhouse and to keep from snapping off the mast, an aluminum tube was glued to the side of the wheelhouse allowing the mast and rigging be removed in transportation, or working around the boat. Inserting the battery under the deck is easy and by adding a Velcro strip, hidden inside the large vent, securing the battery. A small magnet secures the aft hatch above the rudder post.

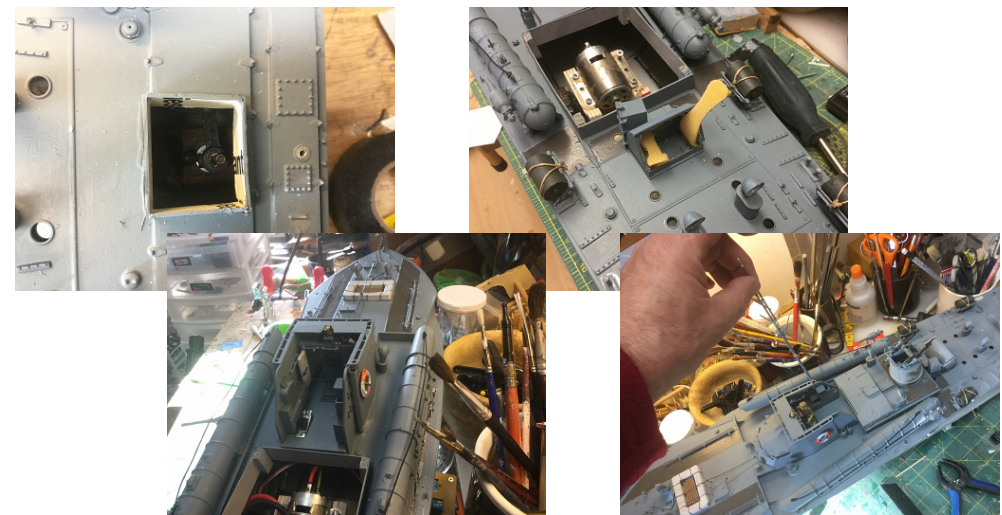

model-boats.com